

Specification;

Material: profiles extruded from alloy 6063 T6 to; BS EN 12020-2:2008 & BS EN 755 part 1-9:2008

Surface quality; for powder coating

Glazing system; Gaskets to Din 7863 & BS EN 3734:1997

Construction; Corners to be constructed using extruded aluminium cleats 70456 and strengthened/sealed with jointing compound 69915 and corner chevrons 63952

APR recomend that the APR 'Flat Rooflight' be fitted with a minimum pitch of 5 degrees & a maximum pitch of 15 degrees

Glass double glazed unit, make up dependant on glass supplier recommendation

Limitations APR do not recommend a Rooflight bigger than 3.1m long X 1.3m wide

APR recommend the use off Dow Corning 993 black structural silicone to bond the glass in the frame and Dow Corning 791 Silicone Weatherseal. Please follow the manufacturers instructions

N.B. Please ensure compatability with glass manufactures edge seal

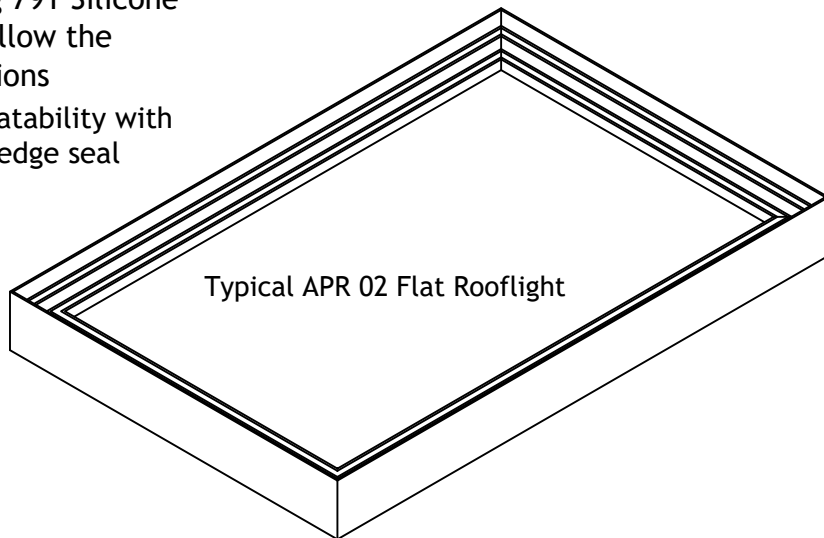
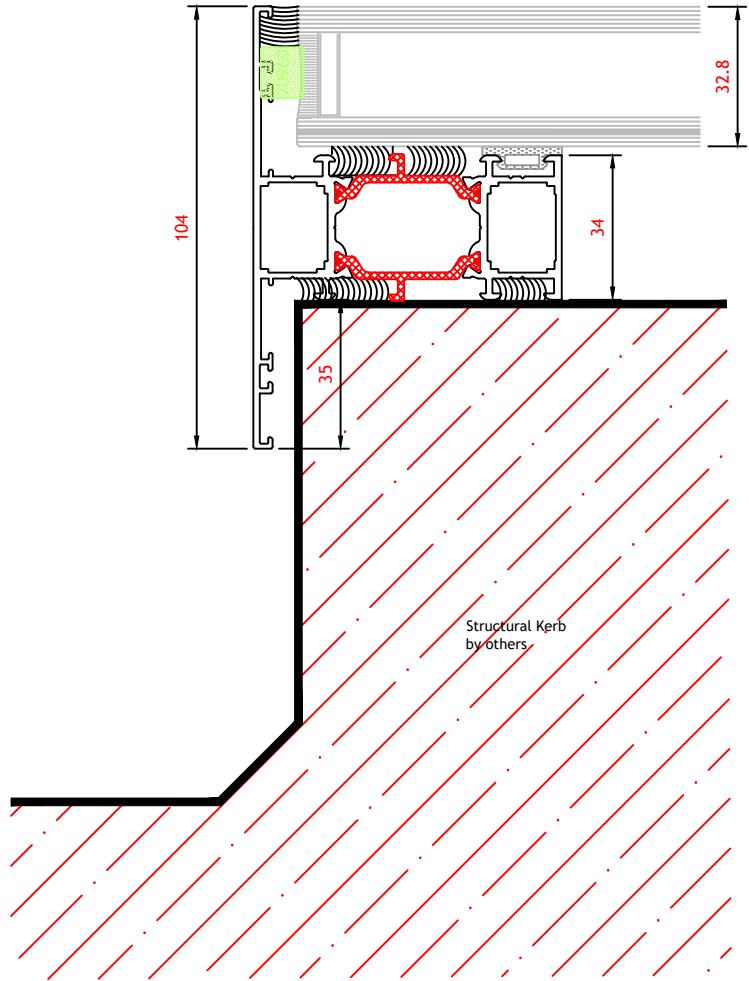

Typical APR 02 Flat Rooflight

D E F

A- B C