

# Ulti-Mate 10K Slate Vent Fixing Instructions

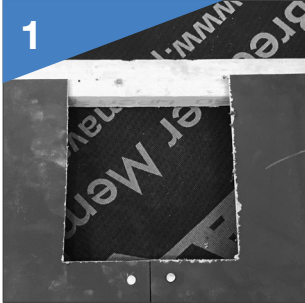

**1**  
Set out the roof and lay the Slates in line with the manufacturers fixing instructions until you reach the area where the vent tile is to be fitted



**5**  
If the Slate Vent is just being used for roof ventilation fit the Slate Vent Adaptor ULTI3SVA and/or also with a Ulti-Mate Flexipipe ULTI3FP for connection to Soil Pipe of Mechanical Extraction, this will require the Underlay to be cut as shown in Section 2

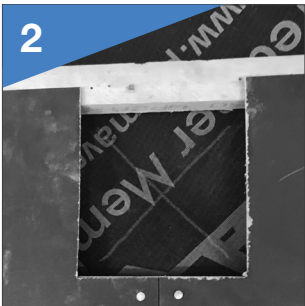

**2**  
Mark a cut line 220mm x 60mm on the two slates below where the Vent is to be fitted, cut out the section and mark the underlay for opening into the roof space if required for future ventilation of connection to Flexipipe

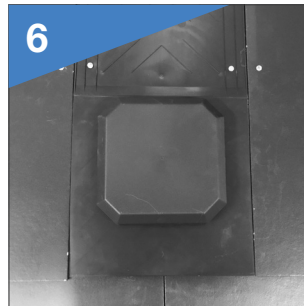

**6**  
Continue by fixing the Slate Vent into the next course of Slates, fixing into the Tile Battens

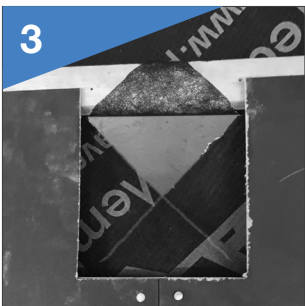

**3**  
Fold back underlay with top section to the fixed to the batten above the opening.

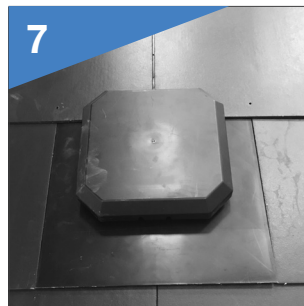

**7**  
Continue slating the remainder of the Roof

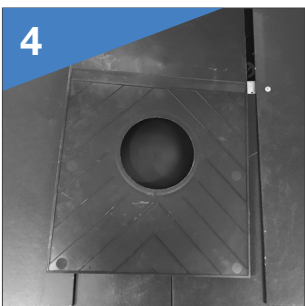

**4**  
If the Slate Vent is only being used to ventilate the Batten Cavity use the 10k Slate Vent without an adaptor, without cutting the Underlay



All products are covered by our 15 year Durability Warranty terms and conditions can be found on our website.



All plastic products are made in UK.